

KEY PLAN: NTS

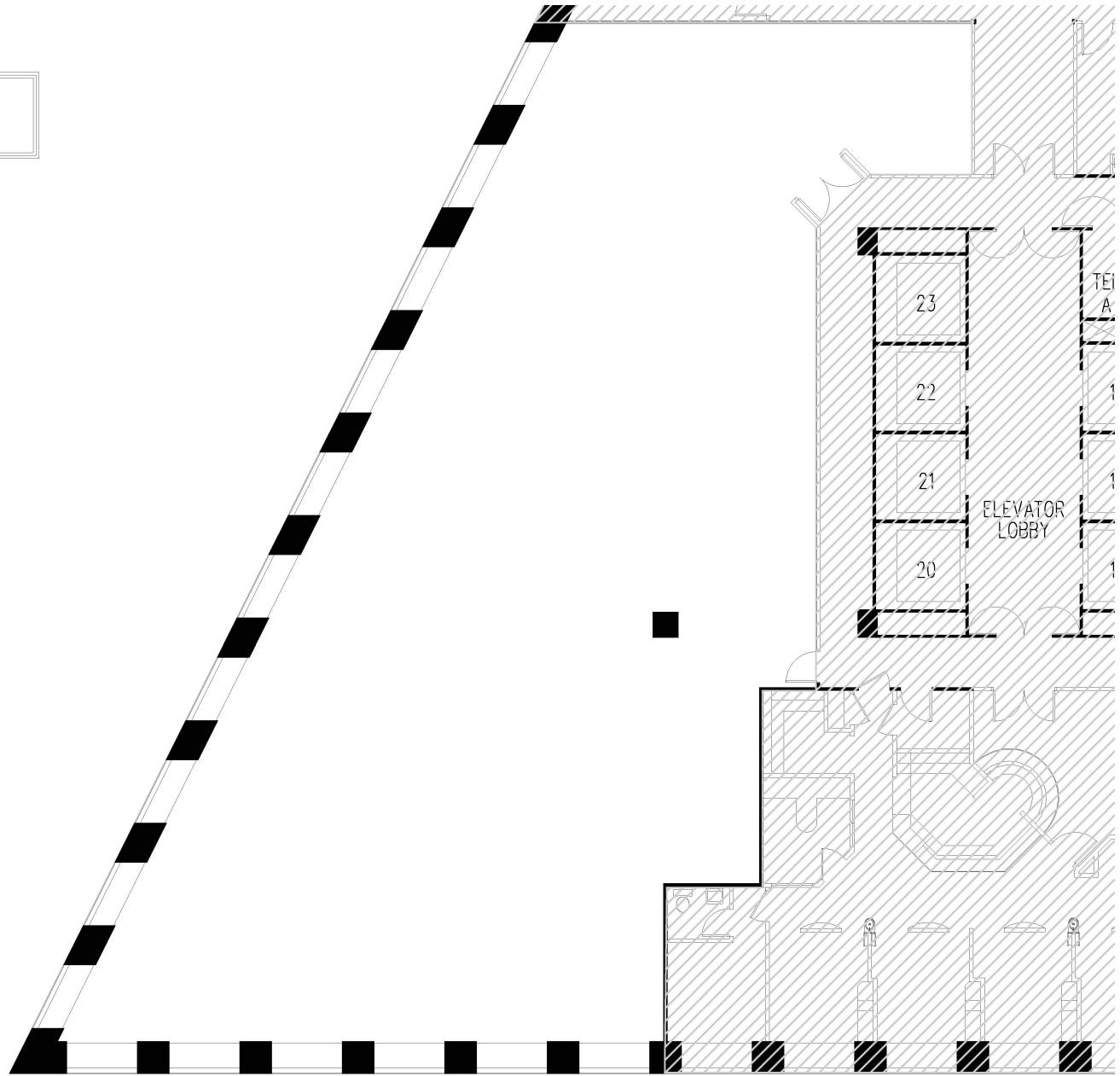

AVAILABLE SUITE

SUITE 4000

6,254 RSF



NTS



GEORGIA-PACIFIC CENTER

**TRANSWESTERN**

*Experience Extraordinary*

Greg Frankum 404.842.6565 [Greg.Frankum@transwestern.com](mailto:Greg.Frankum@transwestern.com)

Matt Spickard 404.842.6566 [Matt.Spickard@transwestern.com](mailto:Matt.Spickard@transwestern.com)